



PAT McCRORY
Governor

NICHOLAS J. TENNYSON
Secretary

March 1, 2016

ADDENDUM # 2

To: Plan Holders
From: Jeffrey E. Alspaugh 
Division 14 Proposal Engineer

RE: **Wall Plans and Letters of Intent Due Date**
Contract ID: DN00455
County: Polk
Letting Date: March 22, 2016

The above contract has experienced the following changes:

- **Retaining Wall Plans have been added as part of the plan set.**
- **Letters of Intent are due no later than Noon, Wednesday, March 23, 2016.**

Please insert this letter and the attached wall plan sheet into the addendum section of the proposal and sign the verification. Thank you for your attention to this matter.



3-7-16 Revision

Sheet 1/2

CONSTRUCTION NOTES & SPECIFICATIONS

- A GENERAL**
- BACKFILL MATERIAL SHALL NOT CONTAIN ORGANIC MATERIAL AND FROST SUSCEPTIBLE SOILS.
 - THE PROVIDED DRAWINGS ARE LIMITED TO THE ITEMS SPECIFIED HEREIN. NO OPINION IS OFFERED, AND NONE SHOULD BE INFERRED REGARDING OTHER ASPECTS OF THIS STRUCTURE, OR THE STRUCTURES TAKE AS A WHOLE. ANY ASSOCIATED REMEDIES EXPRESSED OR REFERENCED ARE EXCLUSIVE TO THE ITEMS SPECIFIED HEREIN. NO WARRANTY IS EXPRESSED OR IMPLIED.
 - ALL WORK SHALL BE IN ACCORDANCE WITH THE CURRENT EDITION OF THE INTERNATIONAL BUILDING CODE, AS ADOPTED AND SUPPLEMENTED BY LOCAL REGULATIONS.
 - IF RUBBER Tired EQUIPMENT NEEDS TO BE USED FOR BACK FILLING, DO NOT TURN EQUIPMENT WHILE STANDING STILL ON GEOGRID.
 - VERIFY ALL DIMENSIONS AND SITE CONDITIONS PRIOR TO START OF CONSTRUCTION. NOTIFY THE ENGINEER OF ANY DISCREPANCIES OR INCONSISTENCIES.
 - NO CHANGES TO THE INFORMATION SHOWN ON THE DRAWINGS OR SUBSTITUTIONS OF MATERIALS SHALL BE MADE WITHOUT THE SPECIFIC WRITTEN APPROVAL OF THE ENGINEER.
 - DESIGN INFORMATION SHOWN ON THE DRAWINGS PROVIDE OVERALL DIMENSIONAL PARAMETERS AND DESCRIBE ELEMENTS TO BE CONSTRUCTED.
 - THE ENGINEER SHALL BE NOTIFIED OF ANY PROPOSED MODIFICATIONS.

- B FOUNDATIONS**
- SEE TABLE 1/5/2
 - FOUNDATION CONDITIONS DIFFERENT TO THE ASSUMED DESIGN PARAMETERS OR TO A GEOTECHNICAL REPORT SHALL BE REPORTED TO THE STRUCTURAL AND GEOTECHNICAL ENGINEER BEFORE FURTHER CONSTRUCTION IS ATTEMPTED.
 - THE BOTTOM OF ALL WALLS SHALL BEAR ON COMPETENT VIRGIN MATERIAL.

N.C. DEPT. OF TRANSPORTATION
DIVISION OF HIGHWAYS
GEOTECHNICAL ENG. UNIT-WRO

X ACCEPTED
ACCEPTED AS NOTED
RETURNED FOR INFORMATION
REJECT

By: Shane Clark, PE
DATE: March 7, 2016

- SITE NOTES / SEQUENCE:**
- LOCATE/VERIFY ALL UTILITIES PRIOR TO CONSTRUCTION
 - TREE REMOVAL BY OWNER/CONTRACTOR PRIOR TO CONSTRUCTION
 - DEMOLITION OF EXISTING WALLS BY CONTRACTOR
 - NEW WALL TO BE INSTALLED PER SITE PLAN/SURVEY; VERIFY ALL SETBACKS, EASEMENTS, PROPERTY LINES PRIOR TO CONSTRUCTION
 - SURFACE DRAINAGE, WATER CONVEYANCE AND DISCHARGE PER PROPERTY OWNER OR CONTRACTOR
 - GEOGRID ELEVATION MEASURED FROM BASE OF WALL
 - GEOGRID LENGTH MEASURED FROM OUTER FACE OF WALL
 - BASE ELEVATION SHALL BE MIN. 24" BELOW GRADE

WALL DESIGN DATA:

RETAINED SOIL FRICTION ANGLE $\phi = 32^\circ$
SOIL UNIT WEIGHT, $\gamma_s = 120$ PCF
COHESION, $C = 0$

BULK UNIT WEIGHT, $\gamma_b = 120$ PCF
REINFORCED BACKFILL, $\phi = 40^\circ$
REINFORCED BACKFILL, $\gamma_r = 115$ PCF

MINIMUM CUT SLOPE FOR DESIGN PURPOSES ONLY. ACTUAL CUT SLOPE BATTER MAY BE GREATER.

NOTE:

- ALL RETAINING WALL BLOCKS TO BE MESA STANDARD BLOCKS FOR SRW WALL.
- ALL GRID MATERIAL TO BE GEOGRID UN1400 MSE. INSTALL PER MANUF. SPECS AND TO PRESCRIBED DIMENSIONS.

NO.	REVISIONS/SUBMISSIONS	Date
1		3-7-16

APPROVED FOR CONSTRUCTION

53 Asheland Avenue,
Suite 101
Asheville, NC 28801
Phone #: (828) 232-4448
Fax #: (828) 232-5224

MEDLOCK & ASSOCIATES
ENGINEERING, P.A.
STRUCTURAL CONSULTING • CONSTRUCTION ASSISTANCE

STATE OF NORTH CAROLINA
DIVISION OF HIGHWAYS
STATE PROJECT REF. NO. R-5756
NORTH CAROLINA
POLK COUNTY

Project No: 420415
S1 OF 2
Drawing Title: SEGMENTAL RETAINING WALL SECTIONS & DETAILS

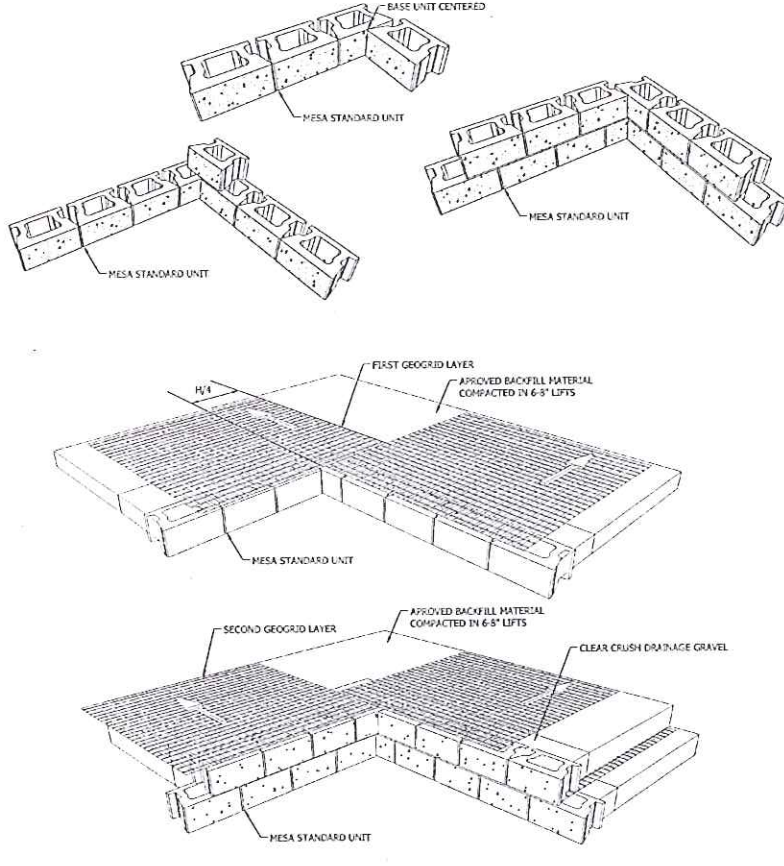
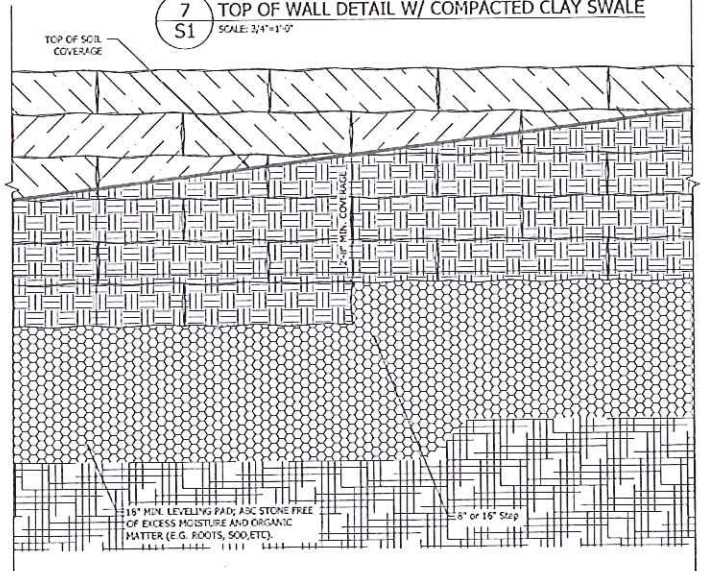
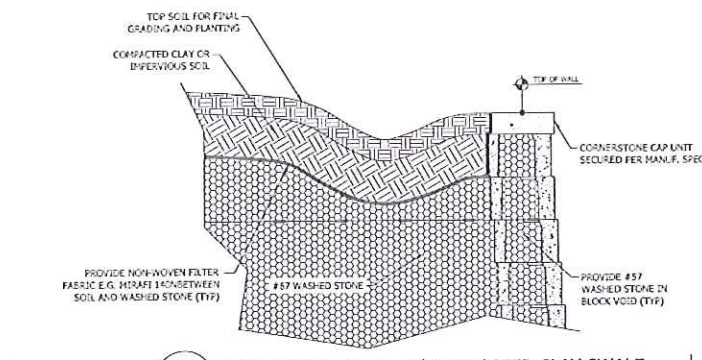
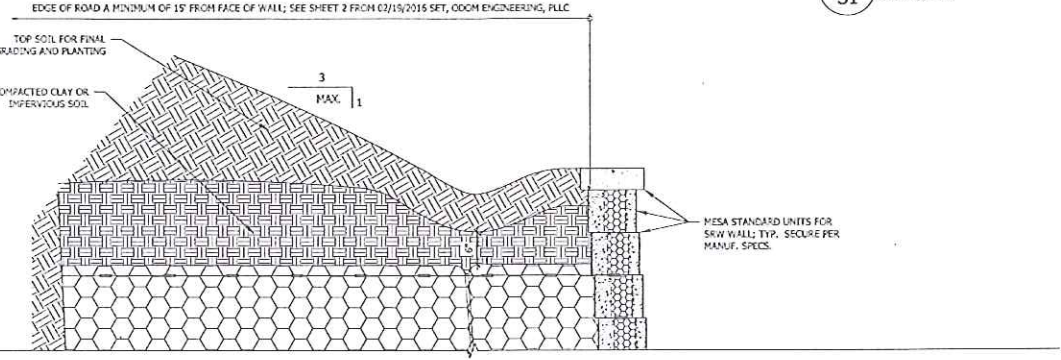
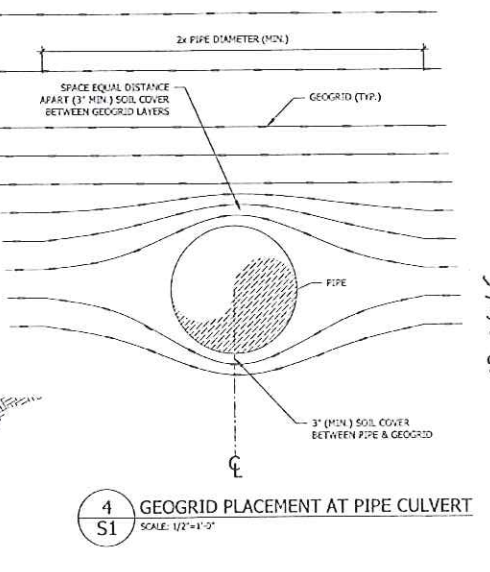
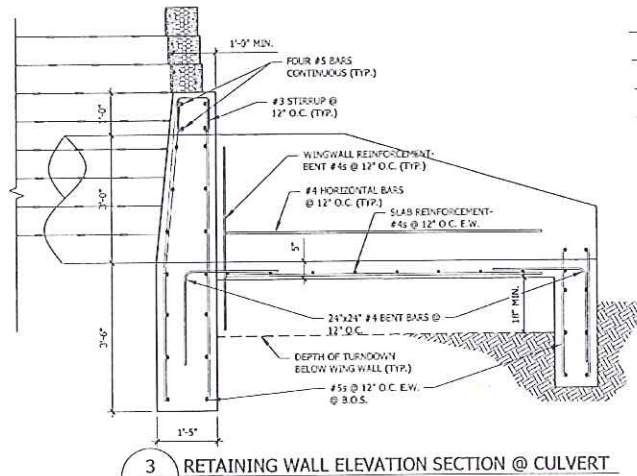
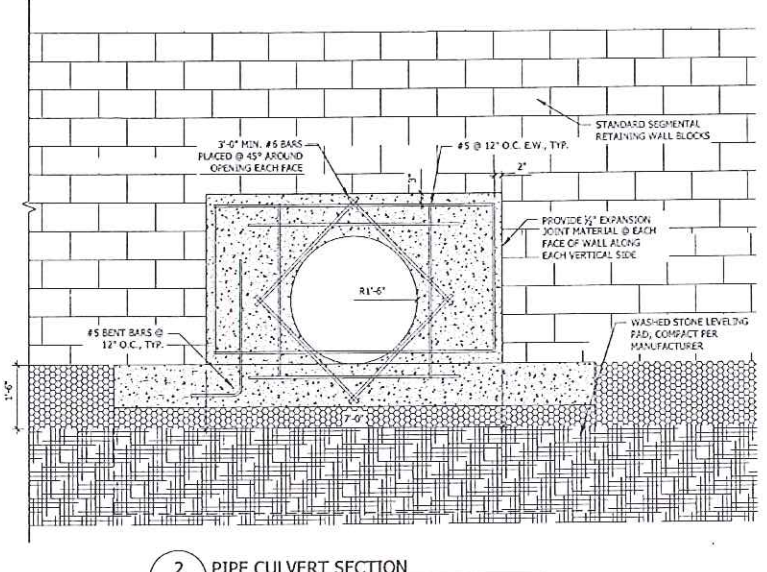
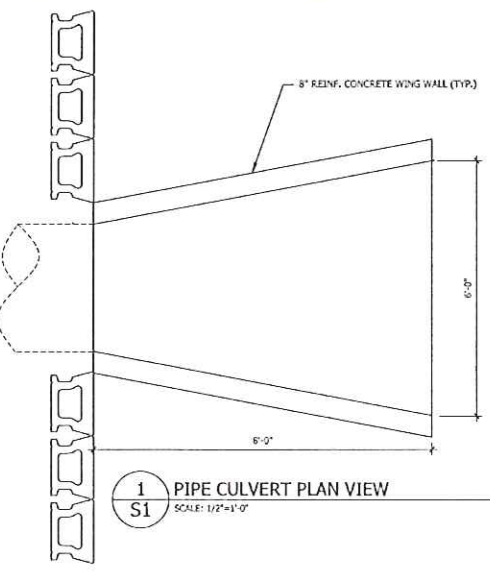

3-7-16 ^{Sheet} 2/2
 REVISION

TABLE 1/S2 : SOIL BEARING PRESSURE		
WALL HEIGHT (FEET)	ACTUAL BEARING PRESSURE BELOW WALL (PSF)	SOIL CLASS
21.0	400	
18.0	400	
15.0	400	
12.0	400	
9.0	400	
6.0	300	

* ACTUAL PRESSURES TAKEN INTO ACCOUNT SHOULDER, SANDWICH & WALL GEOMETRY

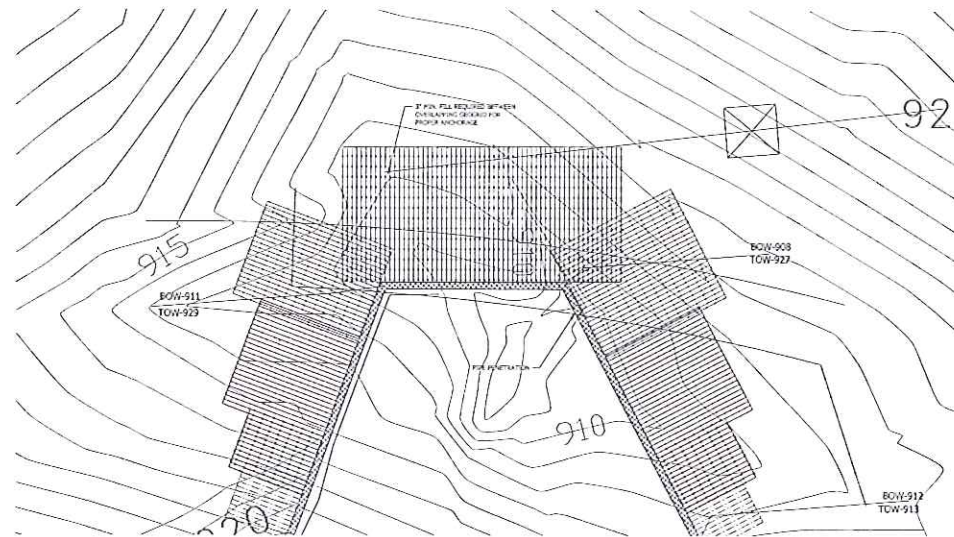
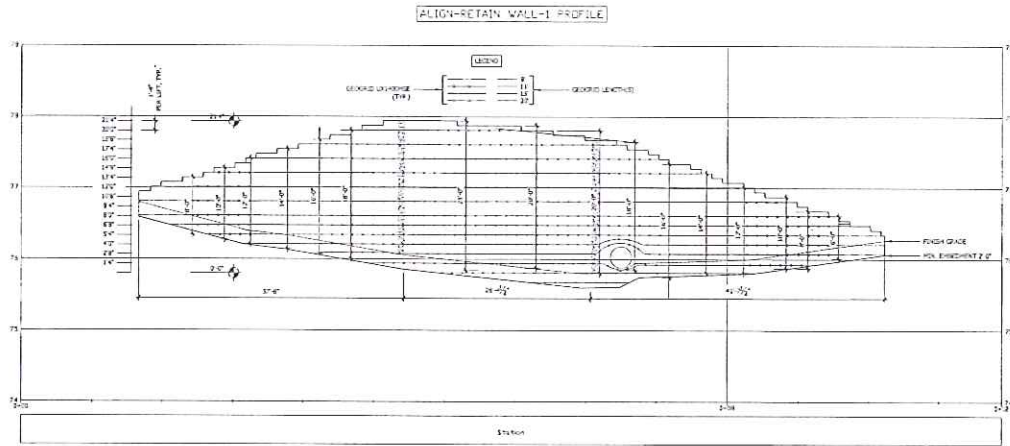

STATE OF NORTH CAROLINA DIVISION OF HIGHWAYS STATE PROJECT REF. NO. R-5756 COUNTY NORTH CAROLINA		JING WALL ELEVATION & LOCATION	
MEDLOCK & ASSOCIATES STRUCTURAL & CONSULTING • CONSTRUCTION ASSISTANCE 53 Ashland Avenue, Suite 101 Asheville, NC 28801 Phone: (828) 252-0284		CONSTRUCTION SET	
Project No. 03-01-16 Date 01-01-2016 Scale 1/4" = 1'-0" Author JCH Checker JCH		REVISIONS/QUANTIFICATIONS	
Project Name City State County		Date Scale	